

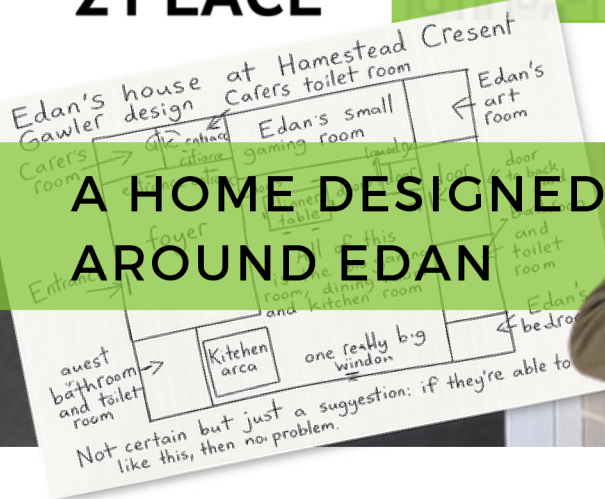

TENANT NEWSLETTER

ACCESS
2 PLACE

JUNE 2026



A HOME DESIGNED AROUND EDAN

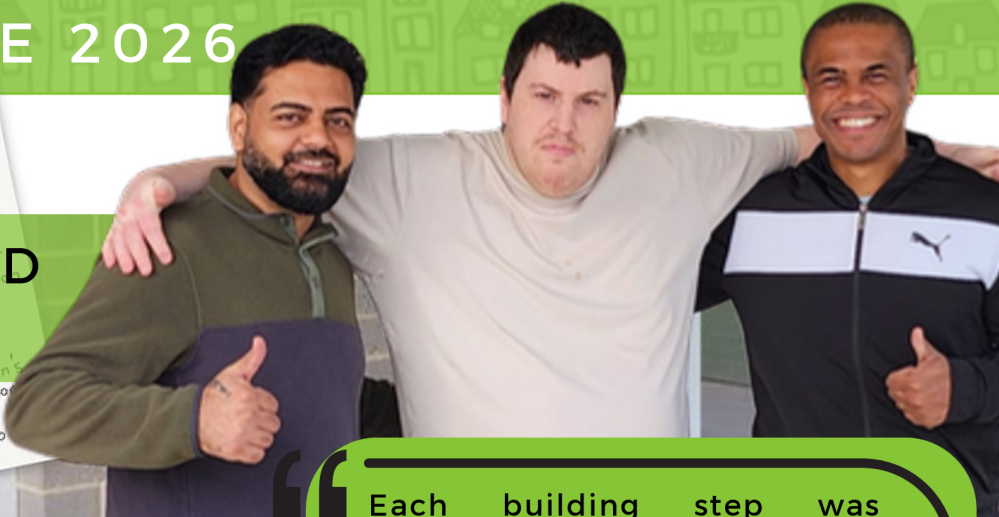

Each building step was carefully crafted taking into consideration Edan's own personally drawn plan and all stakeholders' requirements in order to make this home durable and sustainable for the remainder of Edan's life.

-Edan's mum

When Edan and his family first connected with Access 2 Place, they weren't just looking for another place to live. They were looking for a home that truly felt like Edan.

After lots of moving around and living in homes that didn't quite suit his needs, it was time for something different. Something built around him, his routines, his interests and the way he lives. And Edan wasted no time getting involved.

One of the most special parts of the journey was Edan creating his own hand-drawn floor plan from scratch, sharing exactly what he wanted his future home to look like. From gaming spaces and artwork rooms to colours and layouts, Edan's ideas helped shape the home from the very beginning.

Working together with Edan, his family and support team, Access 2 Place helped bring that vision to life, creating a home that is welcoming, personalised and designed to support him for the long term.

Throughout the build, Edan regularly visited the site to watch his home come to life. When he finally saw the completed property, his reaction said it all.

"He truly believes and feels this is his last move and his forever home."

For Edan and his family, this home represents more than just a building. It's comfort, stability and peace of mind for the future.

Stories like Edan's are a reminder of how important it is to create homes that are designed around the individual and the people who know them best.

How to Apply for SDA

A simple guide to eligibility and the process

Specialist Disability Accommodation (SDA) is housing funded through the NDIS for people with very high support needs or extreme functional impairment.



Talk to your NDIS contact about your housing needs & confirm your SDA eligibility

3 questions to determine eligibility:

- Do you have extreme functional impairment or very high support needs?
- Do you have an SDA needs requirement?
- Does SDA meet the NDIS funding criteria for you?



Complete a Home and Living Supports Request form & gather supporting evidence

Evidence may include:

- Home & Living Supports Request
- Housing Assessment Form
- Statement of Support
- Personal Housing Statement/Plan
- Functional Capacity Assessment
- Psychological Assessment Report



Submit the application & evidence to the NDIA

Work with your NDIS contact to submit the Home and Living Supports Request form and all supporting documentation to the NDIA.

If you don't have a support coordinator, you can submit the application directly.



The NDIA reviews your application & will notify you of their decision

Want to know more about your SDA options? Speak with Access 2 Place — you can explore your housing options while staying with Access 2 Place as your SDA provider.

Meet your Housing Team



Anne Knight
Housing Officer



Simon Farrell
Housing Officer



Tania Ware
Housing Officer



Natasha Miller
Housing Officer

It's always nice to put a face to a name, so we're introducing some of the friendly people in our Housing Team.

Our Housing Officers work closely with tenants across A2P homes and are here to help with tenancy questions, inspections, rent and lease matters, and general housing support.

They can also help point you in the right direction if you're not sure who to speak to.

To contact the team, call **08 8274 6300** or email **info@access2place.com.au**

SEEKING INDIGENOUS ARTISTS

Are you an Aboriginal and/or Torres Strait Islander tenant and artist?

Access 2 Place is looking to commission a piece of tenant artwork to help represent our reconciliation journey. We would love to hear from tenants who may be interested in creating artwork that reflects themes such as connection, culture, community and home.

This opportunity forms part of A2P's ongoing commitment to reconciliation, as we move from our Reflect Reconciliation Action Plan into the next stage of our RAP journey.

Tenant voices, stories and creativity are an important part of the A2P community, and we would be proud to work with a tenant artist on something meaningful.

If you are interested, or would like to find out more, please contact the A2P team on **08 8274 6300** or email **info@access2place.com.au**



UPCOMING EVENTS

Register online using the QR codes below or call us 08 8274 6300

BOWLING DAY

Salisbury



sign up here!

When: Wed 24 June
Where: Bowland Salisbury
4-8 Clayson Road, Salisbury
Time: 12:00pm



sign up here!

MOVIE DAY

Piccadilly

When: Thurs 23rd July
Where: The Piccadilly
181 O'Connell Street, North Adelaide
Movie: Moana - Live Action
Time: 2:45 pm

A Great Morning at our Easter Coffee & Chat

A big thank you to everyone who came along to our Easter Coffee & Chat in April and helped make the morning such a success.. It was a great reminder that sometimes all you need is a cuppa, a chat and a few familiar faces to make the day a little brighter.

We can't wait to see even more tenants, support teams and friends of A2P at future Tenant Engagement Network events.



Tenant Survey 2026



Your voice matters! It not to late to have your say and complete the 2026 Tenant Suruvey.

Scan Me!

Your feedback helps us understand what is working well and where we can improve our housing, maintenance, services and tenant engagement. It also helps us identify common concerns and work towards better solutions for our tenant community.

The survey is short and should only take a few minutes to complete. You can complete it online using the QR code and your unique 4-digit code, or return the printed survey using the pre-paid envelope provided. You can also hand it directly to your A2P Housing Officer.

As a thank you, all completed surveys will go into the draw to **win one of three \$50 vouchers.**

For help or questions, please call **08 8274 6300** or email **info@access2place.com.au**.

Cooks Corner

Veggie + Chicken Noodle Soup

INGREDIENTS

- 1 Tablespoon olive oil
- 1 Onion, chopped
- 2 Carrots, chopped
- 2 Celery sticks, chopped
- 2 Garlic cloves, crushed
- 1 litre chicken stock
- 1 cup cooked shredded chicken
- 1 cup small pasta or noodles
- 1 cup frozen peas or corn

METHOD

STEP 1: HEAT THE OIL IN A LARGE POT AND COOK THE ONION, CARROT, CELERY AND GARLIC FOR A FEW MINUTES UNTIL SOFTENED.

STEP 2: ADD THE STOCK AND BRING TO THE BOIL.

STEP 3: ADD THE NOODLES OR PASTA AND COOK UNTIL SOFT.

STEP 4: STIR THROUGH THE CHICKEN AND VEGETABLES, THEN SIMMER FOR A FEW MORE MINUTES.

STEP 5: SEASON WITH SALT AND PEPPER, THEN SERVE WARM.

